

DEPARTMENT OF PUBLIC HEALTH AND DRAINAGE

TINICUM TOWNSHIP
MUNICIPAL BUILDING
ESSINGTON, PA.

TO THE DEPARTMENT OF HEALTH:

The following abstract of specifications of Plumbing and Drainage, with description and accompanying plan, are submitted for approval:

Location Owner

..... feet of side

No. of stories high Grade of Building

Owner Address

Architect Address

Plumber Address

Register No.

DESCRIPTION OF PLAN AND ABSTRACT OF SPECIFICATIONS

All work, materials and construction to be in accordance with the Rules and Regulations of the Department of Health of Tincicum Township, and to comply therewith in all particulars.

Is connection to be made with sewer What size main trap

Size of main house drain Above or below ground

Size of soil pipe Where does air inlet open

What is the grade of the main drain Minimum ventilation of toilet compartment sq. ft.

FIXTURES IN BUILDING

NEW FIXTURES IN BUILDING—BLACK INK
OLD FIXTURES IN BUILDING—RED INK

Floors	Yard	Basmt	1st	2nd	3rd	4th	5th	6th	7th	8th	9th	Total
Water Closets												
Bath Tubs												
Shower Baths												
Basins												
Sinks												
Laundry Tubs												
Slop Hoppers												
Urinals												
Floor Drains												
Outlets												
Foot Bath												
Washing Machines												
Bidets												
Total												

Fee, \$.....

APPROVED

..... Inspector

DEPARTMENT OF HEALTH
TOWNSHIP OF TINICUM

Plumbing and Drainage

New Work

Old Work

Plan No.

Permit No.

Premises of
Owner.

Filed 19.....

Lot No.

Section No.

REMARKS

Finally inspected and all work found in accordance with the plans, specifications and regulations 19.....

Inspector.

ELEVATION

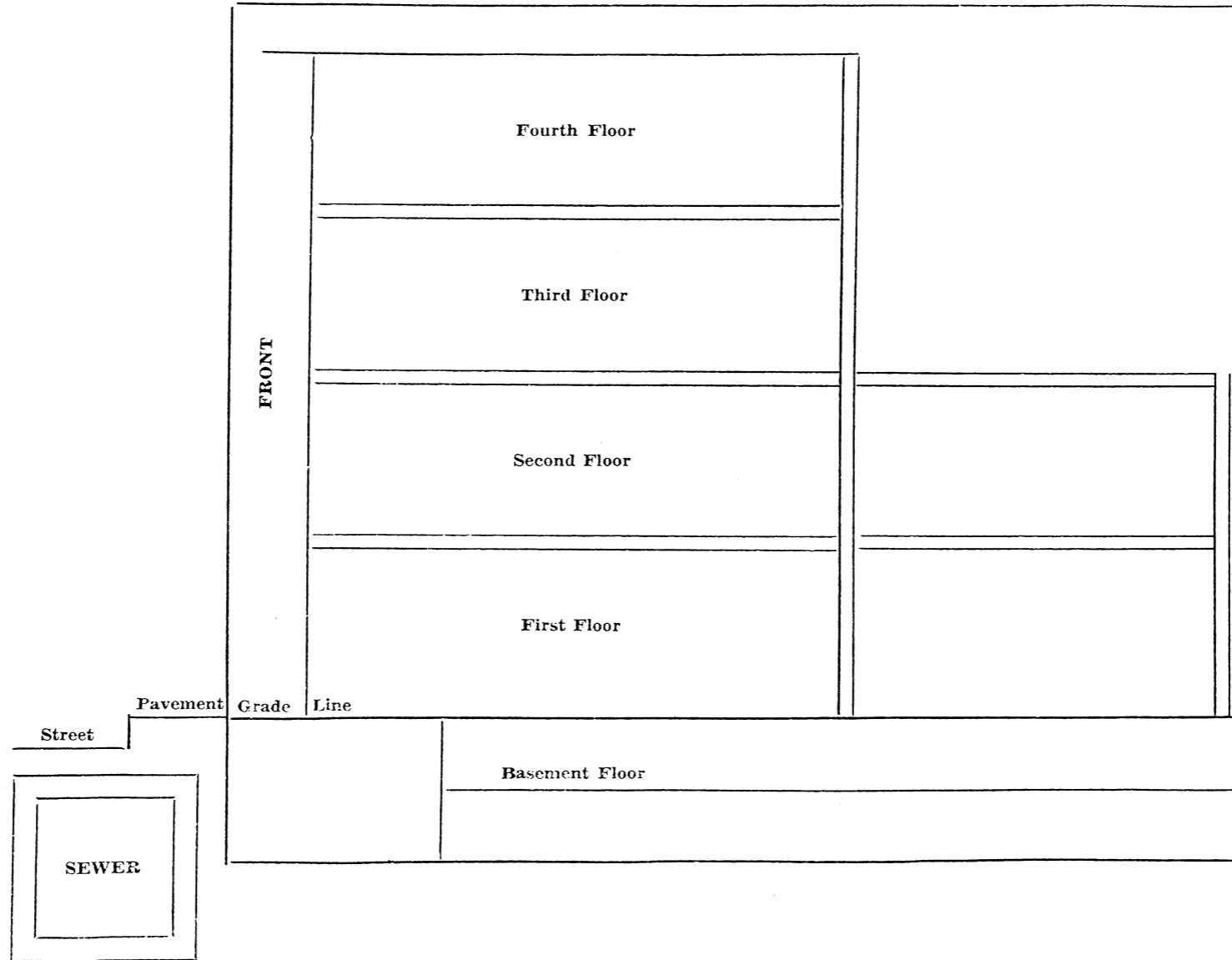

CELLAR PLAN

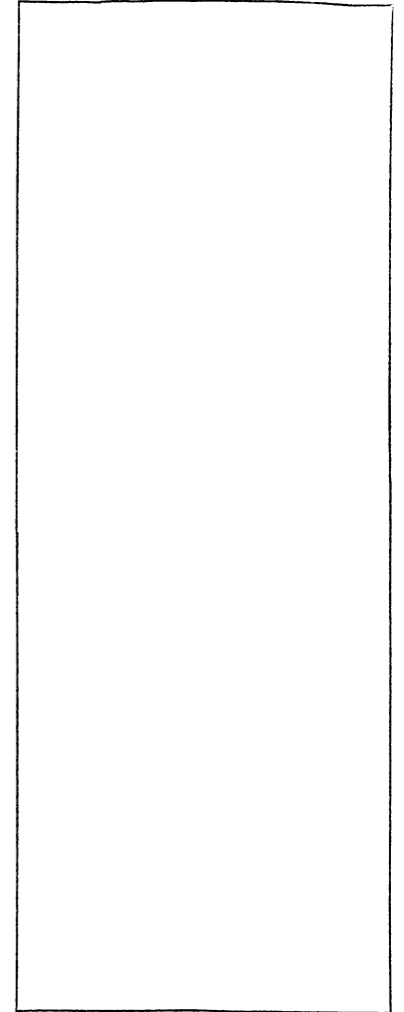

New work to be shown in black ink.
Old work in red ink.